

# DOOR WITH SIDELITE INSTALLATION

1. Apply silicone under threshold and place door in position ON TOP OF FINISH FLOOR. Door can be flush with interior/exterior or centered on stud. Check for level accuracy and shim if necessary.
2. For doors with sidelites: Attach one bracket every two feet on top, left, and right side of the unit using two 1" screws (provided). Be sure that the remaining hole on each bracket extends inward (unless door is placed flush with interior). On hinged side, stay as close as possible to the hinges. Secure brackets to studs with included longer screws.
3. Verify door and lock functionality.
4. Fill gap between door and studs with spray foam sealant.
5. Cover interior side of framing with drywall and exterior side with exterior finish (up to 1 3/8" thick).

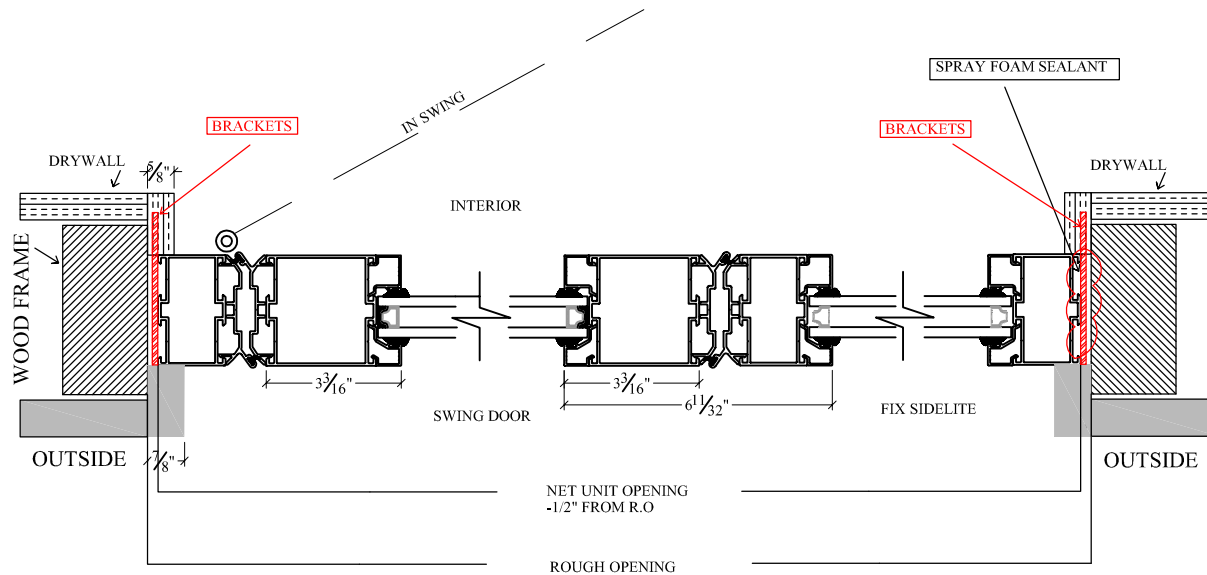

(A) VIEW FROM ABOVE

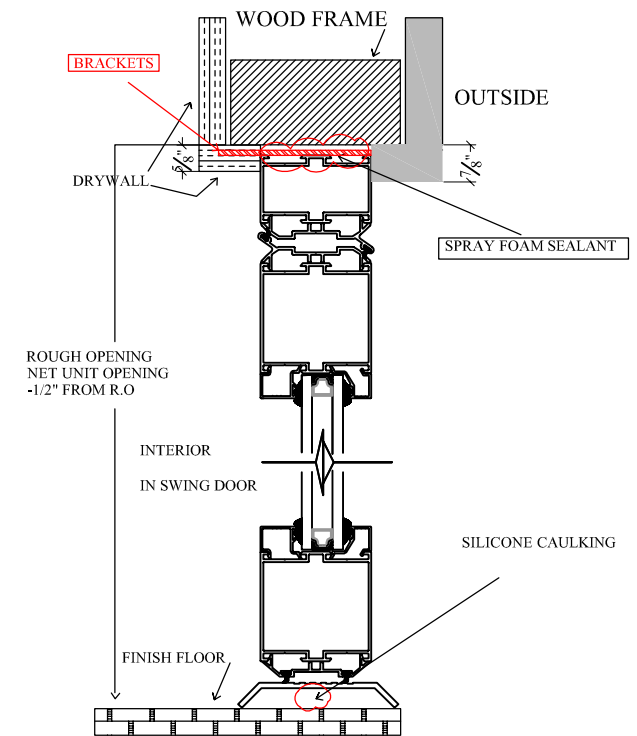
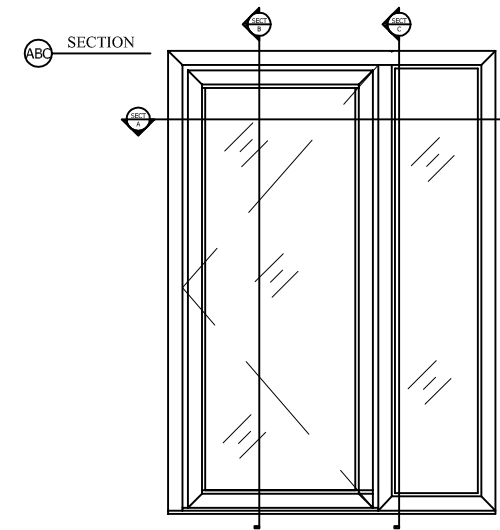

(B) SIDE VIEW